

Desktop Type RF Smart Thermostat for wall-hung boiler

Super strong RF signal for sub1G Communication



English



Version:1.0(09/2023) 71.04.00312

◆ Personalized Scanning Code

Scan the corresponding QR code according to your needs to obtain the content

Manual



- Scan the QR code to obtain the electronic manual in multi-languages.
- Scannen Sie den QR-Code, um das elektronische Handbuch in mehreren Sprachen zu erhalten.
- Escanee el Código QR para obtener un manual electrónico multilingüe.
- Zeskanuj kod QR, aby uzyskać elektroniczną instrukcję w wielojęziku. Сканирование двухмерных кодов для получения многоязычных электронных руководств.

Operation Video & RF Pairing Video



- Scan the QR code to obtain the operation video and RF pairing video
- Scannen Sie den QR-Code, um das Operationsvideo und das HF-Pairing-Video zu erhalten
- Escanear el Código QR para obtener el video de operación y el video de emparejamiento de radiofrecuencia
- Zeskanuj kod QR, aby uzyskać wideo operacyjne i wideo parowania RF
- Сканирование QR - кода для получения видео операций и радиочастотного спаривания

Wi-Fi Config Video



- Scan QR code to obtain Wi-Fi config video.
- Scannen Sie QR-Code, um WLAN-Konfigurationsvideo zu erhalten.
- Escanee el Código QR para obtener el video de configuración Wi-Fi.
- Zeskanuj kod QR, aby uzyskać wideo konfiguracyjne Wi-Fi.
- Сканируйте QR - код, чтобы получить видео конфигурации Wi-Fi.

◆ Standard Accessories

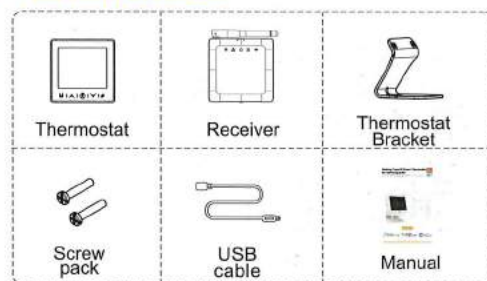

◆ Product Overview

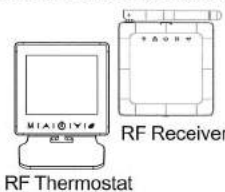

This set controls the temperature of the room by controlling the wall-hung boiler. As long as you install the RF Receiver device near the wall-hung boiler, even if the RF Thermostat is placed in the living room or room (with an open distance of 200 meters), the RF Receiver can be controlled by the RF Thermostat.

◆ Product Overview

| [RF Thermostat] | |
|-----------------------------|--|
| Power supply | 3 x 1.5 V alkaline AA batteries / USB powered (Type-C interface) |
| Temp. setting range | 5~95°C |
| Operation temperature range | -5~50°C |
| Measurement accuracy | 0.1°C |
| Setting temp. accuracy | 0.5°C |
| Transmission distance | ≤200m in the open air |
| Protection level | IP20 |
| Wireless frequency | 433MHz (FSK) / 433MHz (Bidirectional FSK) |

| [RF Receiver] | |
|--------------------------|---|
| Power supply | AC100~240V; 50/60Hz |
| Device power consumption | 1W max |
| Ambient temperature | -5~50°C |
| Transmission distance | ≤200m in the open air |
| Wireless frequency | 433MHz (FSK) / 433MHz (Bidirectional FSK) |

◆ Display Symbols

[RF Thermostat]

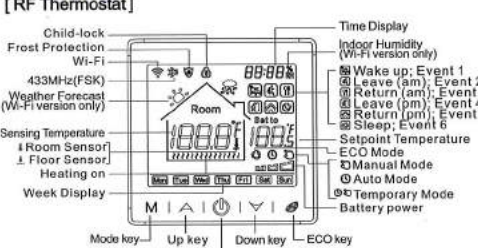

[RF Receiver]

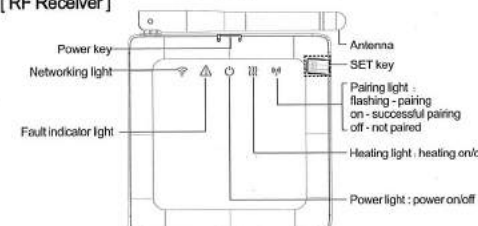

◆ RF Thermostat operating instructions

| Function | Steps |
|---------------------|--|
| Power on/off | Press "power key" shortly to turn on/off the thermostat. |
| Time setting | Press "ECO key" for 3 seconds to set time. |
| Temperature setting | Press "up key" or "down key" shortly to change setting temperature by 0.5°C. |

◆ RF Thermostat operating instructions

| Function | Steps |
|--------------------------|---|
| Temperature control mode | Press "mode key" shortly to switch manual/auto mode. |
| Child-lock | Press "up key" + "down key" for 3 seconds to activate/deactivate child-lock. |
| ECO mode | Press "ECO key" shortly to enter ECO mode (18°C). |
| Weekly programming | During power-on, Press "mode key" for 3 seconds to edit weekly programming. |
| Pairing mode | During power-off, press "mode key" + "ECO key" for 3 seconds to enter pairing mode, until "—" is blinking. |
| Wi-Fi config | During power-off, press "ECO key" for 3 seconds to enter Wi-Fi config, until "—" and "Wi-Fi" is blinking. |
| Low power reminder | When the voltage is less than 3.4 V, the small icon of battery power flickers, it is recommended to replace the new battery as soon as possible before use. |

◆ Weekly programming

Press "mode key" for 3 seconds to edit weekly programming.

| Events | Symbols | Time | | Temperature | |
|----------|---------|---------------|------------------|---------------|------------------|
| | | Default value | Modify | Default value | Modify |
| Weekdays | 1 | 06:00 | Press "▲" or "▼" | 20°C (68°F) | Press "▲" or "▼" |
| | 2 | 08:00 | | 15°C (59°F) | |
| | 3 | 11:30 | | 15°C (59°F) | |
| | 4 | 12:30 | | 15°C (59°F) | |
| | 5 | 17:00 | | 22°C (72°F) | |
| | 6 | 22:00 | | 15°C (59°F) | |
| Weekends | 1 | 08:00 | 20°C (68°F) | | |
| | 2 | 22:00 | 15°C (59°F) | | |

◆ RF Thermostat advanced setting

* Usually for Professional Technicians

During power-off, press "mode key" for 3 seconds to enter advanced setting mode. Set the numerical value by pressing "up key" or "down key", then repress "mode key" to switch to next setting item. Press "power key" to save and exit advanced setting mode.

| Code | Meaning | Press "▲" or "▼" | Default value |
|------|----------------------------|--|---------------|
| 01 | Temp. calibration | -9.9~9.9°C/-9.9~9.9°F | 0°C |
| 02 | Temp. Dif. | 0.5~10°C/1~10°F | ±1°C |
| 03 | Temp. upper limit | 5~95°C/41~199°F | 50°C |
| 04 | Temp. lower limit | 5~47°C/41~117°F | 5°C |
| 05 | Frost protection | ON: frost protection on OFF: frost protection off | OFF |
| 06 | Temperature unit | °C/°F | °C |
| 09 | Weekly programming setting | 12345: 5/2 week mode 123456: 6/1 week mode 1234567: 7/0 week mode | 12345 |
| 12 | Child-lock | 00: Child-lock inactivate when screen off, lock all when child-lock activate 01: Child-lock activate when screen off, lock all when child-lock activate 02: Child-lock activate when screen off, lock all except Fan Speed, Up and Down when child-lock activate 03: Child-lock activate when screen off, lock all except Power on/off when child-lock activate | 00 |
| | | 00: Power OFF | |

◆ RF Receiver operating instructions

| Function | Steps | Display state |
|--------------------------|---|---|
| Power on/off | Press "Power key" shortly | "⊙" Power light is always on/off |
| RF Pairing | During power-on, press "SET key" for 3 seconds | "⊙" Power light is on+ "Ⓢ" Pairing light flashing quickly |
| RF Pairing successful | | Buzzer beeps + "Ⓢ" pairing light is on |
| Forced output | During power-on, press "Power key" for 3 seconds | "⊙" Power light is on+ "Ⓢ" Heating light is blinking |
| | Short press "Power key" to exit the forced output, return to the shutdown state | "Ⓢ" Heating light is off |
| Restore factory settings | During power-off, press "Power key" for 3 seconds | "⊙" "Ⓢ" "Ⓢ" four lights flash once at the same time |

◆ Dimensions (Unit: mm)

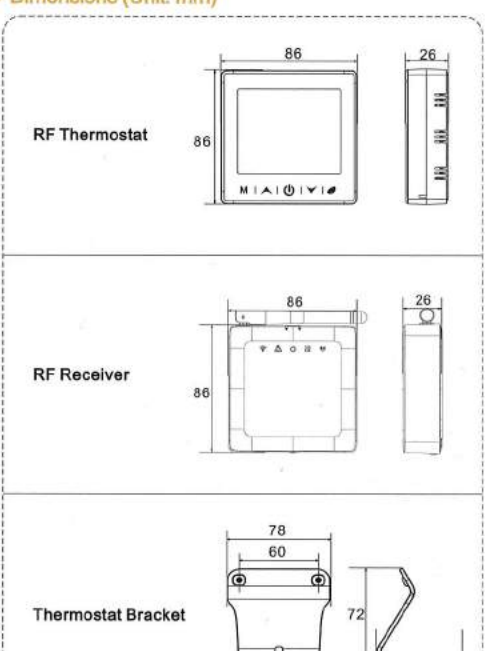



Available on the App Store

GET IT ON Google play

Scan the QR code above or search "Smart Life" on App Store and Google Play to download the Smart Life APP.

2 Registration or Log in



Enter the Register/Login interface; tap "Register" to create an account by entering your phone number to get verification code and "Set password". Choose "Log in" if you already have a Smart Life account.

3 seconds, when the screen flashes "OFF" and "Wi-Fi" the thermostat Enter the state of distribution network;

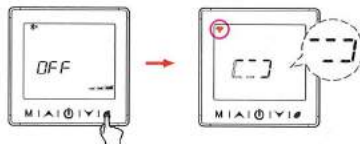

2 Enter the "Home" interface of the APP click "+" in the upper right corner, select the "Add" button in the pop-up window, and finally click "+" to enter the Wi-Fi password interface;



*Please turn on the Bluetooth of your phone in advance.

3 Select 2.4G Wi-Fi and enter the password, click "Next", and then wait for the connection to succeed.



4 After the addition is successful, click "Done", and the Wi-Fi smart thermostat has been added successfully.



Amazon Alexa : Alexa,

- * Turn on the HEATER
- * Turn off the HEATER.
- * Make the HEATER cooler in here.
- * Make the HEATER warmer in here.
- * What is the temperature of the HEATER?
- * Turn on child lock for the HEATER
- * Turn off child lock for the HEATER

Google Assistant : OK google,

- * Turn on the HEATER
- * Turn off the HEATER.
- * Set the HEATER to 26 degree
- * Drop the HEATER by 1 degree
- * Raise the HEATER by 1 degree
- * Turn on child lock for the HEATER
- * Turn off child lock for the HEATER

*Attention:

"HEATER" is the device name, you can also name it yourself. The temperature unit of thermostat and smart speaker must be identical.

RF Receiver installation steps

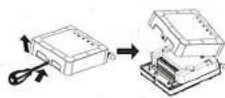

1) After unscrewing the screws, release front cover by inserting a head screw-driver into bottom crack.

2) The user can choose the wiring method as follow.

1 Exposed wiring: Remove the crimping plate from the base, connect the wires, and then install the crimping plate with a screwdriver;

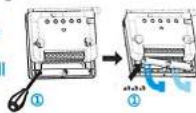

2 Concealed installation and routing: Wire access from bottom to top along the bottom of the base)



3) Put the wire into the terminal and tighten it with a flat-blade screwdriver. After tightening the terminal screws, cover the upper cover to complete the installation. (Example: Passive wiring)



Safety Caution! Very Important! Switch OFF the power for the HVAC system when wiring.

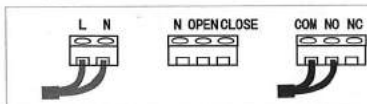

Power cable

Signal line

RF Receiver wiring diagram

The thermostat operates in full capacity in areas with the altitude of less than 2500m above sea level. Power rating of external load should be less than or equal to 80% rated power of the thermostat in areas with altitude of 2500m to 4200m.

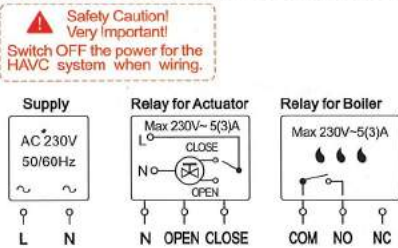

Pairing steps

1 During power-on, press "SET key" for 3 seconds, pairing light "P" flashing, the receiver enters the pairing state.

2 During power-off, press "mode key"+"ECO key" for 3 seconds, the thermostat enters the pairing state.

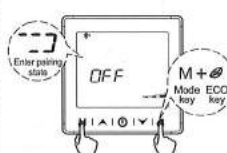
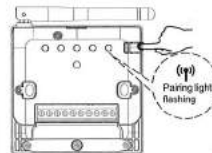

Pairing steps

3 When the receiver's buzzer beeps once, and the pairing light "P" is always on, the pairing is successful.

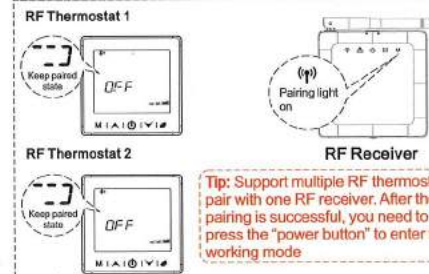

Tip: Support multiple RF thermostats to pair with one RF receiver. After the pairing is successful, you need to short press the "power button" to enter the working mode

APP Remote Control And Voice Control (Wi-Fi version only)



Installation location

The installation distance between the thermostat and the receiver does not exceed 200m (the distance can be judged according to the actual network coverage)

* Tip: There are two main ways to install the RF thermostat

1 desktop placement

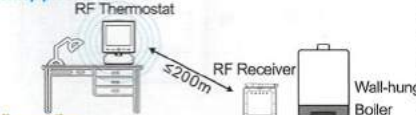

2 wall mounting



* Note: ≤200m in the open air.

RF Thermostat mounting steps

* Note: two power supply methods We suggest using both power supply methods simultaneously

1 3 x 1.5 V alkaline AA batteries

* Note:

1 It is recommended to use brand new 1.5 V alkaline AA batteries.

2 Please ensure the correct polarity when installing the battery.



1) Insert a screwdriver into the notch on the back of the thermostat, pry open the base and panel frame;



2) Put the battery into the battery compartment of the device. After inserting the battery, close the back cover to complete the

RF Thermostat mounting steps

2 USB powered (Type-C interface)

Pass the Type-C cable through the notch of the bracket, and use it to power the device.

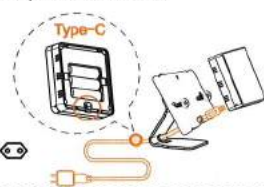

RF Thermostat mounting steps

1 desktop placement

1 Release back plate by inserting a head crew-driver into bottom crack.

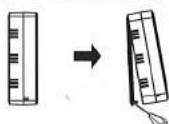

2 Mount backing plate into thermostat bracket, put screws and then fix thermostat.

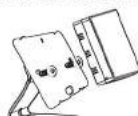

RF Thermostat mounting steps

3 Re-mount the front cover via snap-fit connection.



2 wall mounting

1 Release back plate by inserting a head crew-driver into bottom crack.

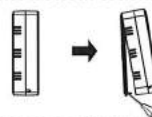

2 Mount backing plate into wall-cassette, put screws and then fix thermostat.

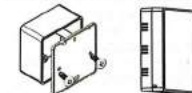

3 Re-mount the front cover via snap-fit connection.

